

Product Description



Electrical type: isolated LED driver (suitable for Class II light fixtures)

Category: AC220-240V, flicker-free

Product Feature: adjustable output current via a dip switch, flicker-free, high PF, high efficiency, Ta 55°C

Application: built-in type; specifically designed for EU-standard LED track light

Warranty: 5 years (Please refer to the warranty condition.)

Certificate: ENEC, CE, CB, RCM, CCC



Technical Data

Full Model Number		LF-GIF022YF			
Output	Output Voltage	30-42VDC			
	Output Current	350mA	400mA	450mA	500mA
	Ripple Voltage	≤1V			
	Current Tolerance	±5%			
	Start-up Time	≤ 0.5 s			
	Temperature Drift	±10%			
	Line Regulation	±5%			
Input	Line Regulation	±5%			
	Input Voltage	220-240VAC (voltage limit: 198-264VAC)			
	Input Frequency	47-63Hz			
	Input Current	0.13A Max.			

Model	LF-GIF022YF	Series	EU-Standard, Flicker-Free, Built-In Type, for LED Track Light
-------	-------------	--------	---

Input	Power Factor (full load)	≥0.90/200VAC	≥0.95/200VAC	
		≥0.90/230VAC	≥0.94/230VAC	
		≥0.89/264VAC	≥0.90/264VAC	
	THD	≤20% @220-240VAC 500mADC		
	Efficiency (full load)	≥86%/200VAC	≥87%/200VAC	
		≥86%/230VAC	≥87%/230VAC	
		≥86%/264VAC	≥87%/264VAC	
Inrush Current	<60A/350uS@230VAC			
Stand-by Power	≤0.5W			
Protective Feature	Open Circuit Protection	≤ 55VDC		
	Short Circuit Protection	Hiccup mode (auto-recovery)		
Environment Condition	Working Temperature	-30°C ~ +55°C		
	Working Humidity	20-90%RH (no condensation)		
	Storage Temperature/Humidity	-40°C ~ 80°C(six months under class I environment); 10-90%RH (no condensation)		
	Atmospheric Pressure	86-106KPa		
	Withstand Voltage	I/P-O/P: 3.75KV, <5mA, 60s		
	Insulation Resistance	I/P-O/P: 500VDC, >100MΩ		
	Surge Rating	Conform to IEC61000-4-5 (L-N: 1KV)		
	Electromagnetic Interference	EN55015		
	Electromagnetic Susceptibility	Conform to EN61000-4-2, 3, 4, 5, 6, 8, 11; EN61547		
Others	Packaging (Weight)	Carton dimension: 385*285*210mm (L*W*H); 54g±5%/pc; 8.35kg±5%/ctn; Quantity: 140 (20*7) pcs/ctn		
	Warranty Condition	5 years (Tc ≤ 87 °C)		
Testing Equipment	AC power source: CHROMA6530, digital power meter: CHROMA66202, Oscilloscope: Tektronix DPO3014, DC electronic load: M9712B, LED board, constant temperature and humidity chamber, lightning surge generator: Everfine EMS61000-5B, rapid group pulse generator: Everfine EMS61000-4A, spectrum analyzer: KH3935, hi-pot tester: TH9201B, stroboscope (percent flicker tester) 60N-01, etc.			
Testing Condition	Unless otherwise stated, the parameters of the power factor and efficiency are the test results under the ambient temperature of 25°C and humidity of 50%, AC input of 230V and 100% load.			
Additional Remark	<ol style="list-style-type: none"> 1. It is recommended that customer should install protection devices for surge and for over & under voltage to ensure safety before connecting to electricity. 2. The PC cover, housing, end caps and other parts of the LED driver inside the LED light fixture must conform to UL94-V0 flammability standard or above. 3. As an accessory, the LED driver is not the only factor determining the EMC performance of the LED light fixture. The structure and the wiring of the light fixture are also relevant. Thus it's strongly recommended the LED light fixture manufacturer re-confirms the EMC of the whole LED light fixture. 			

Circuit Breaker & Relevant Parameters

Name	Value	Remark
Surge peak current (I _{peak})	18A	Input voltage 230Vac
Surge half-peak time (T _{widch})	180μs	Input voltage 230Vac. Measure the time for I _{peak} to drop to its half value.
Quantity of the same model driver that type-B 16A circuit breaker can configure.	40 pcs (maximum)	

Driver quantities are below if use another type of circuit breaker.

Type	Rank	Qty of accommodated drivers	Relative conversion ratio
B	10A	25 pcs	63%
	13A	32 pcs	81%
	16A	40 pcs	100% (benchmark)
	20A	50 pcs	125%
	25A	62 pcs	156%
C	10A	41 pcs	104%
	13A	54 pcs	135%
	16A	68 pcs	170%
	20A	83 pcs	208%
	25A	104 pcs	260%

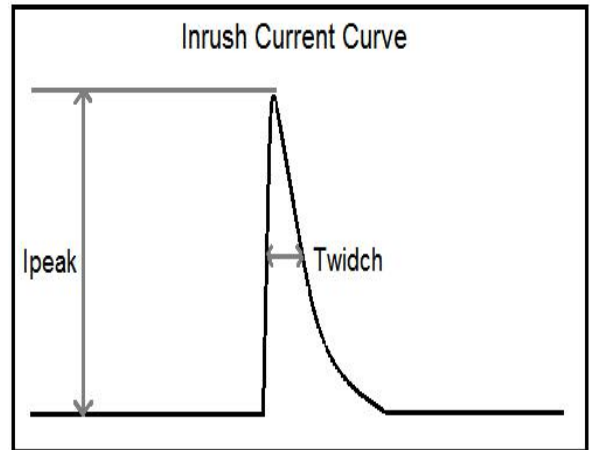

DIP Switch Table

Ta	VO DC	Current	1	2	Output power
55°C	30V-42V	350mA	-	-	14.7W
		400mA	ON	-	16.8W
		450mA	-	ON	18.9W
		500mA	ON	ON	21W

Lifetime Curve

The curve below illustrates the driver's lifetime data when the its maximum case temperature in an airtight space reaches 40°C, 50°C, 60°C, 70°C, 80°C and 90°C.

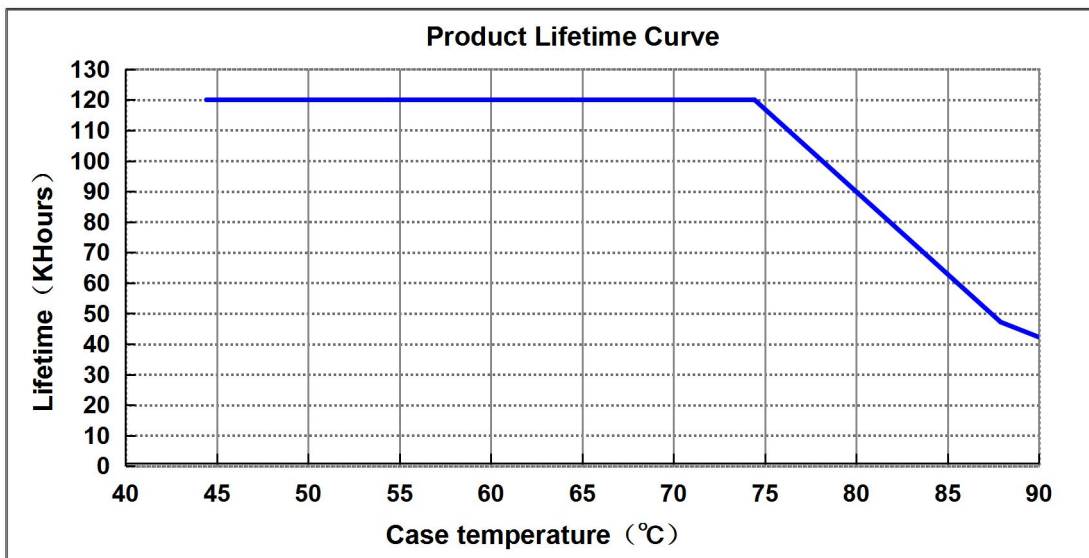

TC Spot (on the bottom cover)

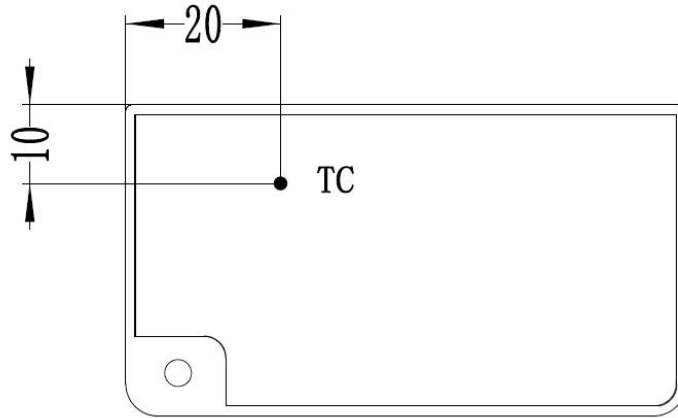

Label

1	LED Driver(LED控制装置)	<table border="1"> <tr> <th>Rated(CC)</th> <th>1</th> <th>2</th> </tr> <tr> <td>350mA</td> <td>-</td> <td>-</td> </tr> <tr> <td>400mA</td> <td>on</td> <td>-</td> </tr> <tr> <td>450mA</td> <td>-</td> <td>on</td> </tr> <tr> <td>500mA</td> <td>on</td> <td>on</td> </tr> </table>	Rated(CC)	1	2	350mA	-	-	400mA	on	-	450mA	-	on	500mA	on	on
Rated(CC)	1		2														
350mA	-		-														
400mA	on		-														
450mA	-	on															
500mA	on	on															
2	Model:LF-GIF022YF																
OFF — ON	Input:220-240V~ 50/60Hz Max.0.13A																
Input	Output Voltage:30-42V== Prated:21W(Max)																
AC-L	U out:55V PF:≥0.9C ta:55°C	Preparation for input and output 															
AC-N	For LED modules only tc:90°C																
0.75-1.5	www.lifud.com	Made in China (中国制造)															
		Output															
		<table border="1"> <tr> <td>LED+</td> </tr> <tr> <td>LED-</td> </tr> </table> 0.5-1.0	LED+	LED-													
LED+																	
LED-																	

Dimension (unit: mm, tolerance: +0.5mm)

L*W*H = 73*40.5*25 (mm)

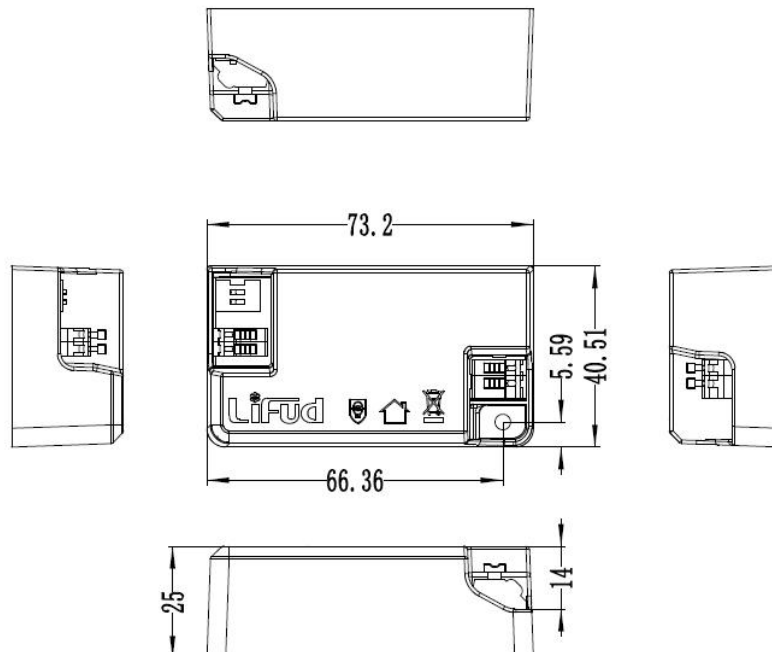

Model	LF-GIF022YF	Series	EU-Standard, Flicker-Free, Built-In Type, for LED Track Light
-------	-------------	--------	---

Wiring Diagram

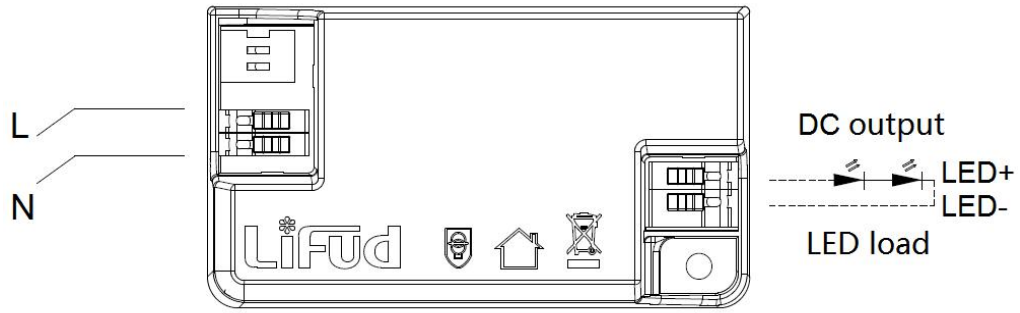

Packaging Specification

Model number	LF-GIF022YF
Dimension of a carton	385 * 285 * 210mm (L * W * H)
Quantity	20 pcs/layer; 7 layers/ctn; 140 pcs/ctn
Weight	54 g ± 5 g/pc; 8.35 Kg ± 0.6 Kg/ctn

Product Feature Curve

Efficiency curve

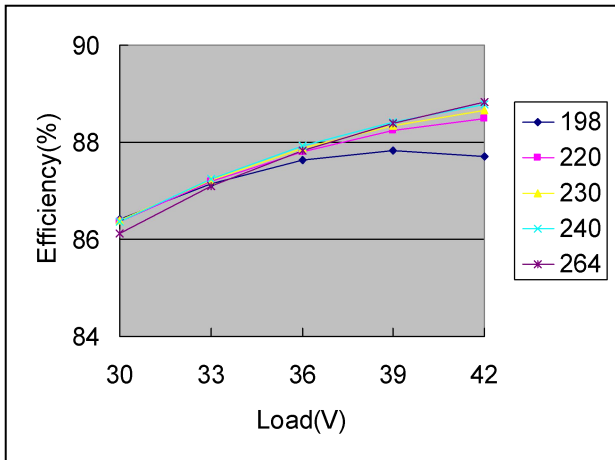

THD curve

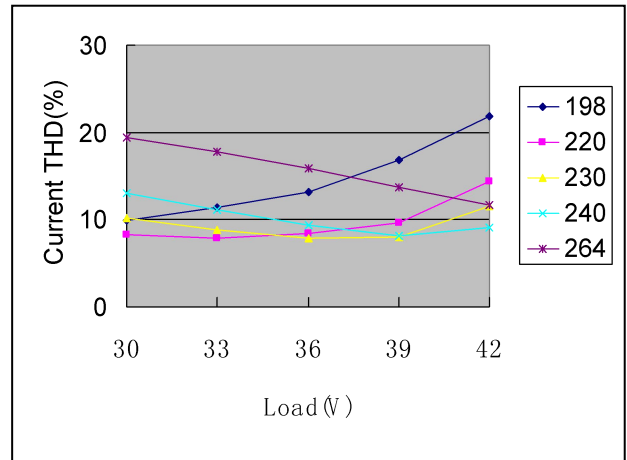

Output current curve

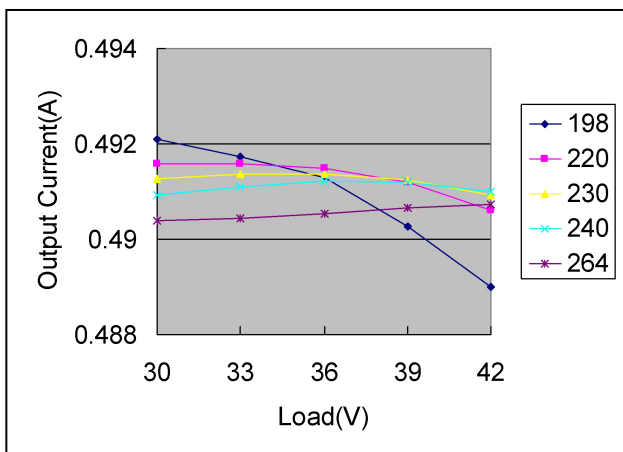

PF curve

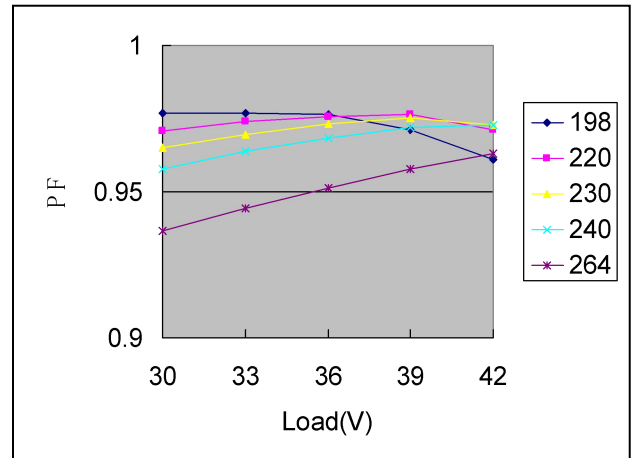

Remark: The final right of interpretation of contents of this data sheet belongs to Lifud Technology Co., Ltd.

Model	LF-GIF022YF	Series	EU-Standard, Flicker-Free, Built-In Type, for LED Track Light
-------	-------------	--------	---