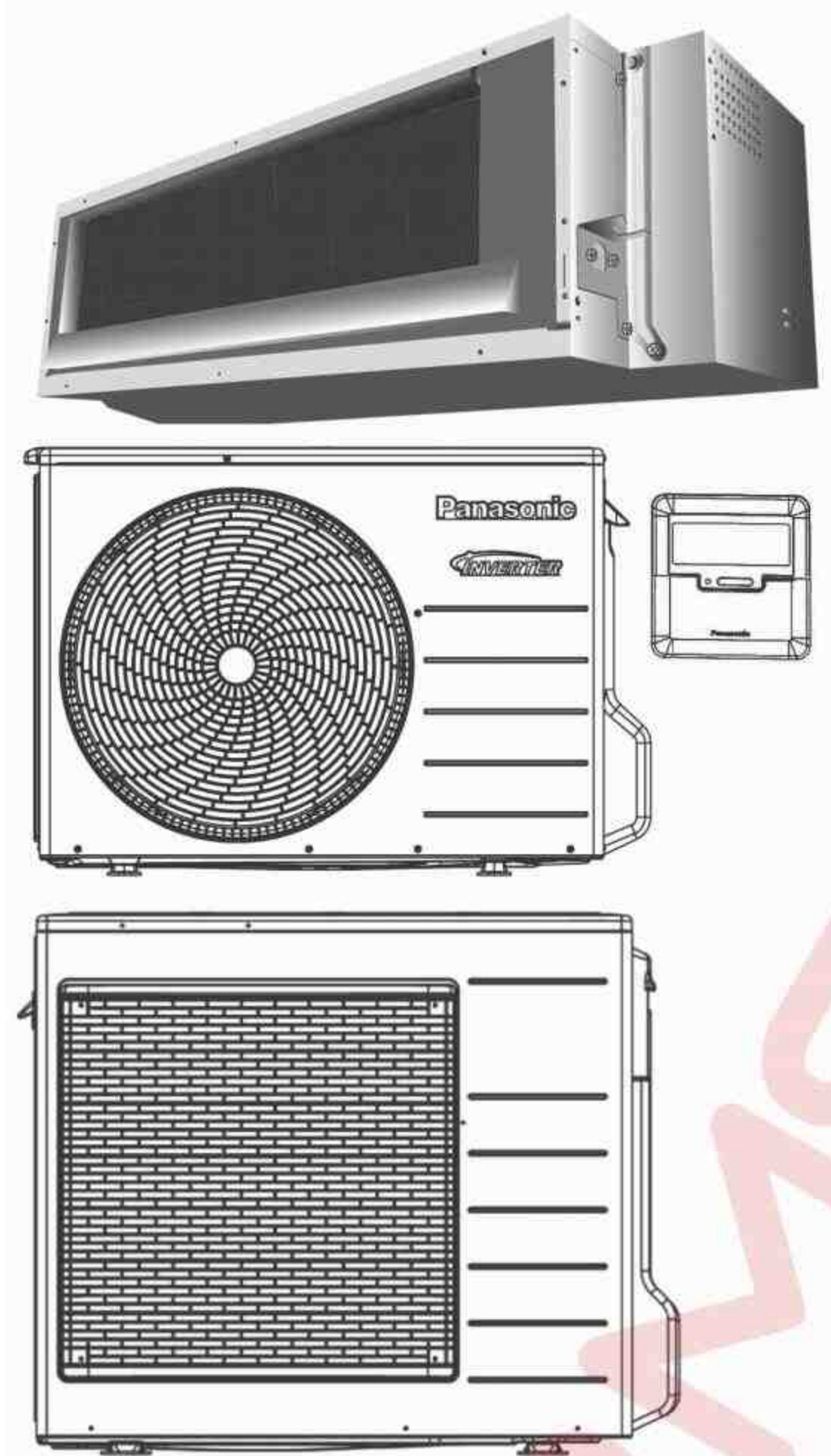

Service Manual

Air Conditioner**Indoor Unit**
CS-E12QD3RW
CS-E18QD3RW**Outdoor Unit**
CU-E12QD3R
CU-E18QD3R**Destination**
Oceania

Please file and use this manual together with the service manual for Model No. CU-4E23QBR CU-4E27QBR CU-5E34QBR, Order No. PAPAMY1404064CE

⚠ WARNING

This service information is designed for experienced repair technicians only and is not designed for use by the general public. It does not contain warnings or cautions to advise non-technical individuals of potential dangers in attempting to service a product. Products powered by electricity should be serviced or repaired only by experienced professional technicians. Any attempt to service or repair the product or products dealt with in this service information by anyone else could result in serious injury or death.

IMPORTANT SAFETY NOTICE

There are special components used in this equipment which are important for safety. These parts are marked by ⚠ in the Schematic Diagrams, Circuit Board Diagrams, Exploded Views and Replacement Parts List. It is essential that these critical parts should be replaced with manufacturer's specified parts to prevent shock, fire or other hazards. Do not modify the original design without permission of manufacturer.

⚠ PRECAUTION OF LOW TEMPERATURE

In order to avoid frostbite, be assured of no refrigerant leakage during the installation or repairing of refrigerant circuit.

Panasonic®

© Panasonic Corporation 2014

19. Exploded View and Replacement Parts List

19.1 Indoor Unit

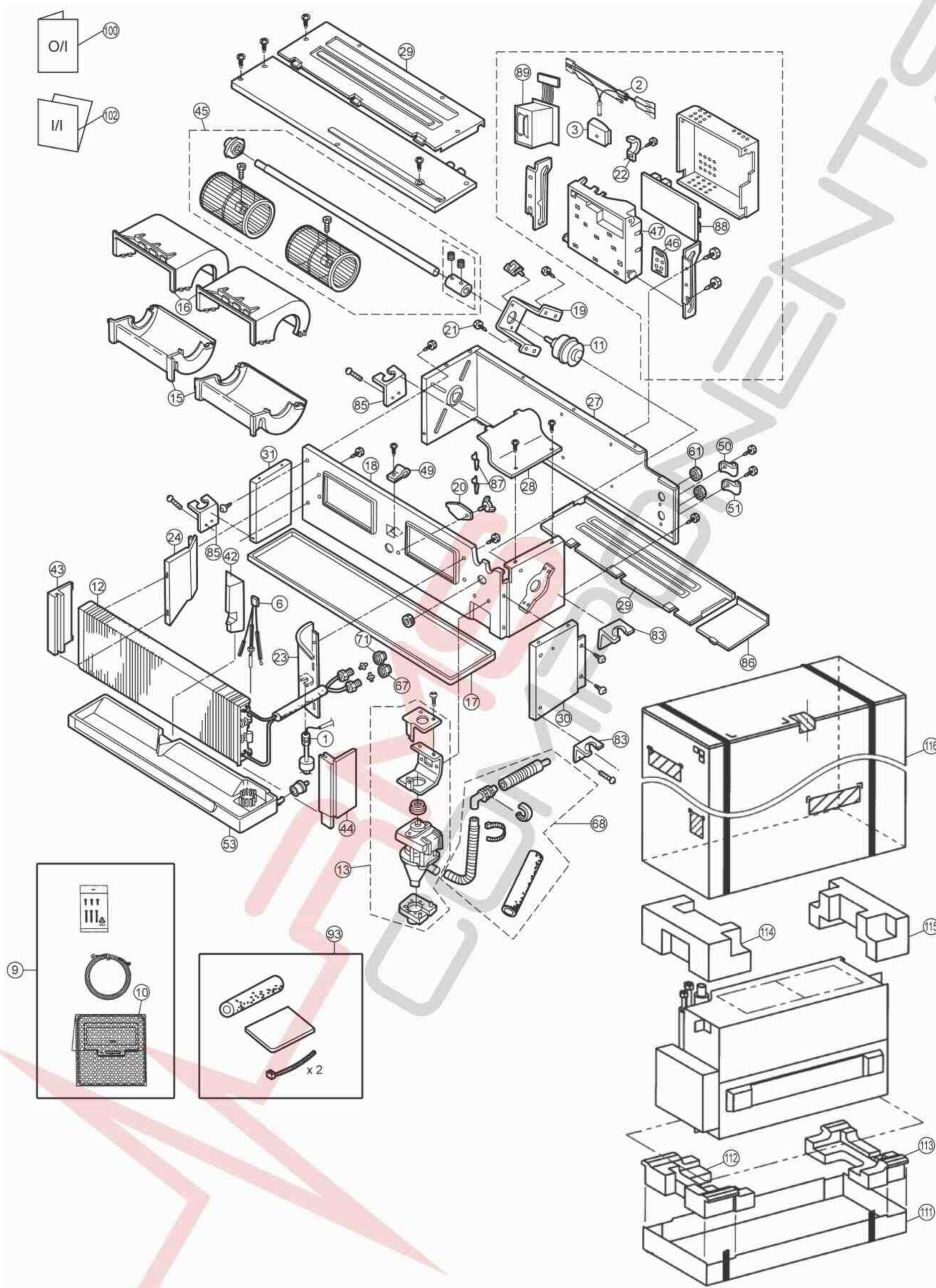

Note:
The above exploded view is for the purpose of parts disassembly and replacement.
The non-numbered parts are not kept as standard service parts.

SAFETY	REF NO.	PART NAME & DESCRIPTION	QTY.	CS-E12QD3RW	CS-E18QD3RW	REMARK
	1	OVER LOAD PROTECTOR	1	CWA12161	←	O
	2	FUSE - COMPLETE	1	CWA16C1038	←	O
⚠	3	TERMINAL BOARD ASS'Y	1	CWA28K1045J	←	O
	6	SENSOR - COMPLETE	1	CWA50C2556	←	O
	9	WIRED REMOTE CONTROL COMPLETE (WITH CABLE)	1	CWA75C4398	←	O
	10	WIRED REMOTE CONTROL	1	CWA75C4264	←	O
⚠	11	FAN MOTOR, DC 30W 3PH	1	ARW41G8P30AC	←	O
	12	FIN & TUBE EVAPORATER - COMPLETE	1	CWB30C2569	CWB30C2568	
	13	PUMP - COMPLETE	1	CWB53C1010	←	O
	15	AIR GUIDER B.W.	2	CWD32091	←	
	16	AIR GUIDER B.W.	2	CWD32092	←	
	17	BASE PAN	1	CWD52259	←	
	18	BULKHEAD	1	CWD531019	←	
	19	FAN MOTOR BRACKET	1	CWD541036	←	
	20	FLAT PIECE	1	CWD74100	←	
	21	SCREW - FAN MOTOR BRACKET	4	CWH55315J	←	
	22	HOLDER - P.S. CORD	1	CWH31044	←	
	23	PARTICULAR PLATE - A'SSY	1	CWD90K080	CWD90K086	
	24	PARTICULAR PLATE	1	CWD90616	CWD90635	
	27	CABINET REAR PLATE	1	CWE02079	←	
	28	CABINET TOP PLATE	1	CWE03034	←	
	29	CABINET TOP PLATE	2	CWE03035	←	
	30	CABINET SIDE PLATE (RIGHT)	1	CWE04071	CWE04079	
	31	CABINET SIDE PLATE (LEFT)	1	CWE04072	CWE04080	
	42	FOAMED POLYSTYRENE	1	CWG07165	CWG07174	
	43	FOAMED POLYSTYRENE	1	CWG07166	CWG07175	
	44	FOAMED POLYSTYRENE	1	CWG07167	CWG07176	
	45	BLOWER WHEEL - COMPLETE	1	CWH01C005	←	
	46	CONTROL BOARD	1	CWH102208	←	
	47	CONTROL BOARD (BOTTOM PCB)	1	CWH10527	←	
	49	HOLDER - P.S. CORD	1	CWH31103	←	
	50	HOLDER - P.S. CORD	1	CWH31030	←	
	51	A-PIECE	1	CWD77013	←	
	53	DRAIN PAN - COMPLETE	1	CWH40C061	←	
	61	BUSHING	1	CWH51134	←	
	67	UNION NUT	1	CWT251030	←	
	68	FLEXIBLE PIPE - COMPLETE	1	CWH85C008	←	
	71	UNION NUT	1	CWT251032	←	
	83	PARTICULAR PIECE	2	CWD93435	←	
	85	PARTICULAR PIECE	2	CWD93436	←	
	86	CABINET BOTTOM PLATE	1	CWE05012	←	
	87	HOLDER - SENSOR	2	CWH32137	←	
⚠	88	ELECTRONIC CONTROLLER	1	CWA73C8578	CWA73C8579	O
⚠	89	TRANSFORMER - COMPLETE	1	CWA40C1027	←	O
	93	ACCESSORY - COMPLETE	1	CWH82C1649	←	
	100	OPERATING INSTRUCTION	1	CWF569674	←	
	102	INSTALLATION INSTRUCTION	1	CWF616459	←	
	111	BASE BOARD	1	CWG62099	CWG62100	
	112	SHOCK ABSORBER (RIGHT)	1	CWG712936	CWG712938	
	113	SHOCK ABSORBER (LEFT)	1	CWG712946	CWG712948	
	114	SHOCK ABSORBER	1	CWG712937	CWG712939	

SAFETY	REF NO.	PART NAME & DESCRIPTION	QTY.	CS-E12QD3RW	CS-E18QD3RW	REMARK
	115	SHOCK ABSORBER	1	CWG712947	CWG712949	
	116	C.C. CASE	1	CWG565694	CWG563247	

(Note)

- All parts are supplied from PAPAMY, Malaysia (Vendor Code: 00029488).
- "O" marked parts are recommended to be kept in stock.

19.2 Outdoor Unit

19.2.1 CU-E12QD3R

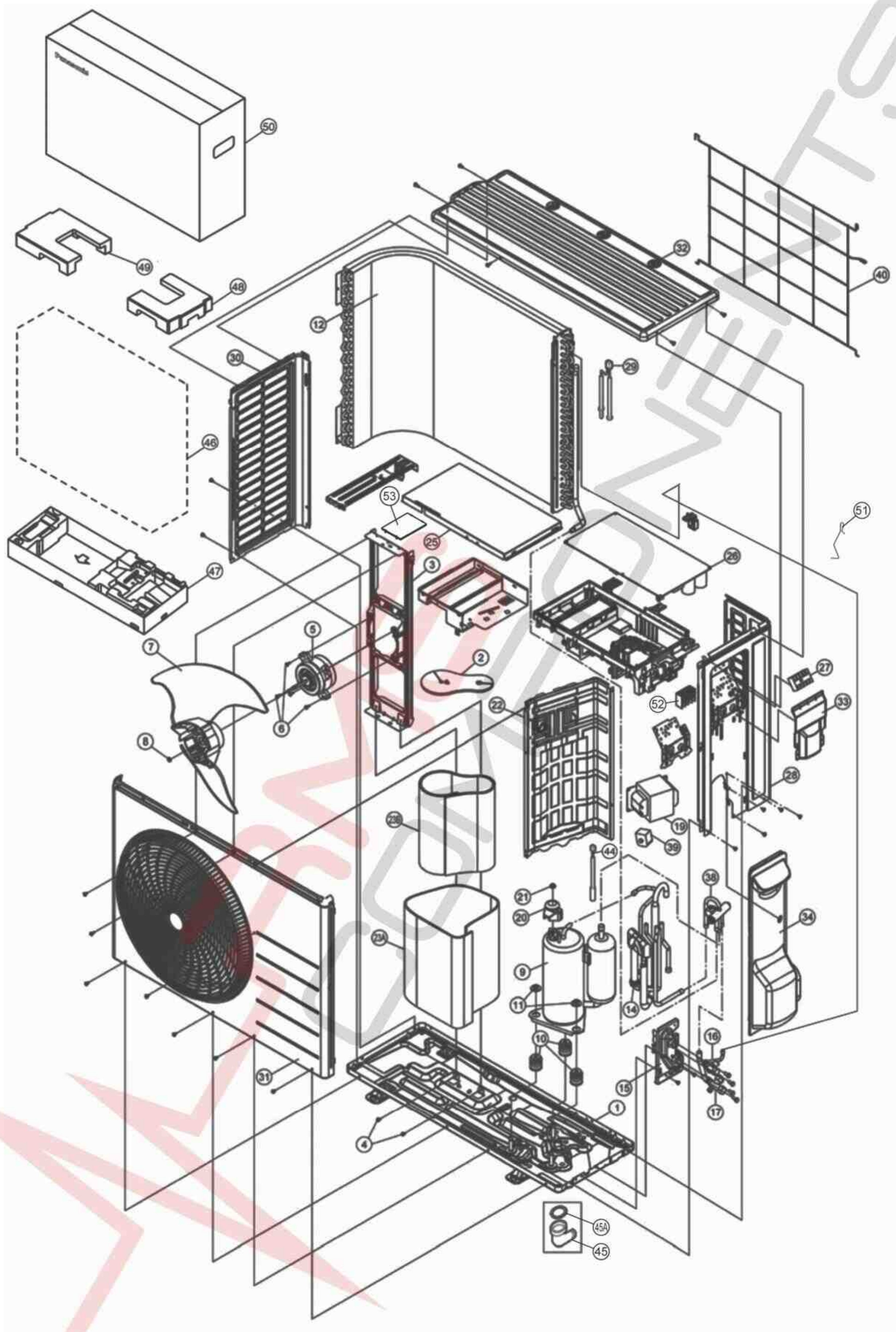

Note:

The above exploded view is for the purpose of parts disassembly and replacement.
The non-numbered parts are not kept as standard service parts.

SAFETY	REF NO.	DESCRIPTION & NAME	QTY.	CU-E12QD3R	REMARK
	1	CHASSIS ASSY	1	CWD52K1277	
	2	SOUND PROOF MATERIAL	1	CWG302719	
	3	FAN MOTOR BRACKET	1	CWD541167	
	4	SCREW - FAN MOTOR BRACKET	2	CWH551217	
⚠	5	FAN MOTOR	1	ARS6411AC	O
	6	SCREW - FAN MOTOR MOUNT	4	CWH55252J	
	7	PROPELLER FAN ASSY	1	CWH03K1066	
	8	NUT - PROPELLER FAN	1	CWH56053J	
⚠	9	COMPRESSOR	1	5RS102XNA21	O
	10	ANTI - VIBRATION BUSHING	3	CWH50077	
	11	NUT - COMPRESSOR MOUNT	3	CWH561096	
	12	CONDENSER	1	CWB32C3218	
	14	DISCHARGE MUFFLER (4-WAY VALVE)	1	CWB121010	
	15	HOLDER - COUPLING	1	CWH351233	
	16	2 WAYS VALVE (LIQUID)	1	CWB021400	O
	17	3 WAYS VALVE (GAS)	1	CWB011367	O
⚠	19	REACTOR	1	G0C193J00003	O
	20	TERMINAL COVER	1	CWH171039A	
	21	NUT-TERMINAL COVER	1	CWH7080300J	
	22	SOUND PROOF BOARD	1	CWH151274	
	23A	SOUND PROOF MATERIAL	1	CWG302726	
	23B	SOUND PROOF MATERIAL	1	CWG302701	
	25	CONTROL BOARD COVER (TOP)	1	CWH131473	
⚠	26	ELECTRONIC CONTROLLER - MAIN	1	CWA73C8582R	O
⚠	27	TERMINAL BOARD ASSY	1	CWA28K1110J	O
	28	CABINET SIDE PLATE COMPLETE	1	CWE04C1296	
	29	SENSOR COMPLETE (AIR & PIPE TEMP.)	1	CWA50C2825	O
	30	CABINET SIDE PLATE (LEFT)	1	CWE041579A	
	31	CABINET FRONT PLATE CO.	1	CWE06C1360	
	32	CABINET TOP PLATE	1	CWE031148A	
	33	CONTROL BOARD COVER	1	CWH131470A	
	34	CONTROL BOARD COVER COMPLETE	1	CWH13C1253	
	38	4 WAYS VALVE	1	CWB001063	O
⚠	39	V-COIL COMPLETE (4-WAYS VALVE)	1	CWA43C2447	O
	40	WIRE NET	1	CWD041166A	
	44	SENSOR COMPLETE (COMP. TEMP.)	1	CWA50C2830	O
	45	DRAIN HOSE	1	CWH5850080	
	45A	PACKING	1	CWB81012	
	46	BAG	1	CWG861078	
	47	BASE BOARD - COMPLETE	1	CWG62C1144	
	48	SHOCK ABSORBER (RIGHT)	1	CWG713415	
	49	SHOCK ABSORBER (LEFT)	1	CWG713416	
	50	C.C. CASE	1	CWG566848	
	51	HOLDER SENSOR	1	CWH32143	
⚠	52	TERMINAL BOARD ASSY	1	CWA28K1281	O
⚠	53	ELECTRONIC CONTROLLER - DEMAND CONTROL	1	CWA747605	O

(NOTE)

- All parts are supplied from PAPAMY, Malaysia (Vendor Code: 00029488).
- "O" marked parts are recommended to be kept in stock.

19.2.2 CU-E18QD3R

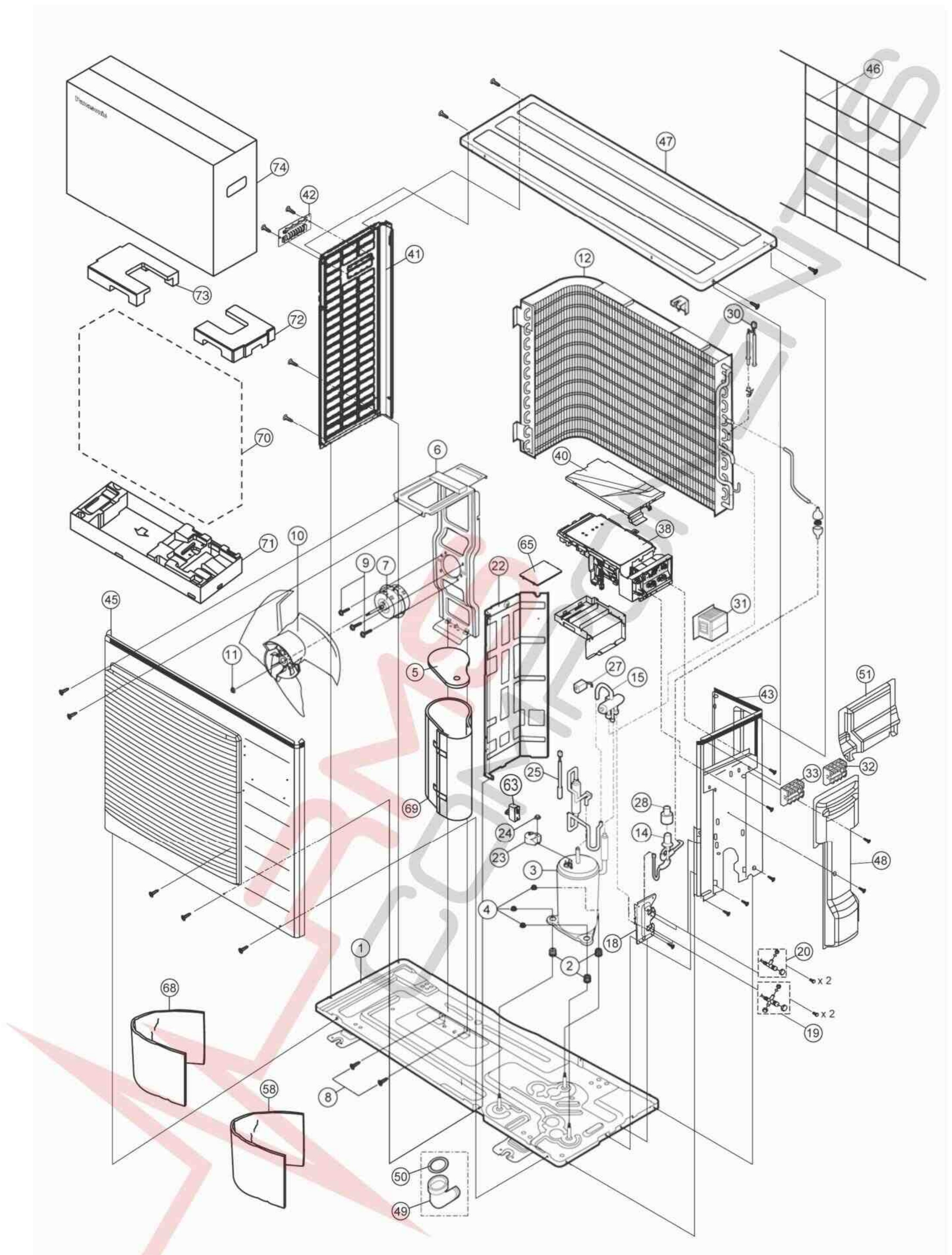

Note:
The above exploded view is for the purpose of parts disassembly and replacement.
The non-numbered parts are not kept as standard service parts.

SAFETY	REF NO.	DESCRIPTION & NAME	QTY.	CU-E18QD3R	REMARK
	1	CHASSIS ASSY	1	CWD52K1191	
	2	ANTI - VIBRATION BUSHING	3	CWH50077	
⚠	3	COMPRESSOR	1	5RD132XBC21	O
	4	NUT - COMPRESSOR MOUNT	3	CWH561096	
	5	SOUND PROOF MATERIAL	1	CWG302656	
	6	FAN MOTOR BRACKET	1	CWD541126	
⚠	7	FAN MOTOR	1	CWA951620	O
	8	SCREW - FAN MOTOR BRACKET	3	CWH551217	
	9	SCREW - FAN MOTOR MOUNT	3	CWH551040J	
	10	PROPELLER FAN ASSY	1	CWH001019	
	11	NUT - PROPELLER FAN	1	CWH561092	
	12	CONDENSER	1	CWB32C4049	
	14	EXPANSION VALVE	1	CWB051016J	O
	15	4 WAYS VALVE	1	CWB001026J	O
	18	HOLDER - COUPLING	1	CWH351227	
	19	3 WAYS VALVE (GAS)	1	CWB011338	O
	20	2 WAYS VALVE (LIQUID)	1	CWB021454	O
	22	SOUND PROOF BOARD	1	CWH151198	
	23	TERMINAL COVER	1	CWH171039A	
	24	NUT - TERMINAL COVER	1	CWH7080300J	
	25	SENSOR CO. (COMP DISC.)	1	CWA50C2656	O
⚠	27	V-COIL COMPLETE	1	CWA43C2169J	O
⚠	28	V-COIL COMPLETE (EXPAND VALVE)	1	CWA43C2257	O
	30	SENSOR CO. (AIR AND PIPE TEMP.)	1	CWA50C2517	O
⚠	31	REACTOR	1	G0C153J00007	O
⚠	32	TERMINAL BOARD ASSY	1	CWA28K1281	O
⚠	33	TERMINAL BOARD ASSY	1	CWA28K1110J	O
⚠	38	ELECTRONIC CONTROLLER - MAIN	1	CWA73C8583R	O
	40	CONTROL BOARD COVER (TOP)	1	CWH131333	
	41	CABINET SIDE PLATE COMPLETE	1	CWE041317A	
	42	HANDLE	1	CWE161010	
	43	CABINET SIDE PLATE	1	CWE041318A	
	45	CABINET FRONT PLATE CO.	1	CWE06K1084	
	46	WIRE NET	1	CWD041128A	
	47	CABINET TOP PLATE	1	CWE031083A	
	48	CONTROL BOARD COVER COMPLETE	1	CWH13C1185	
	49	DRAIN HOSE	1	CWH5850080	
	50	PACKING	1	CWB81012	
	51	CONTROL BOARD COVER	1	CWH131332	
	58	SOUND PROOF MATERIAL	1	CWG302521	
⚠	63	CAPACITOR - FM (3.0MF/460V)	1	DS461305QP-A	
⚠	65	ELECTRONIC CONT. - NOISE FILTER	1	CWA747986	O
	68	SOUND PROOF MATERIAL	1	CWG302766	
	69	SOUND PROOF MATERIAL	1	CWG302629	
	70	BAG	1	CWG861154	
	71	BASE BOARD - COMPLETE	1	CWG62C1082	
	72	SHOCK ABSORBER	1	CWG712879	
	73	SHOCK ABSORBER	1	CWG712880	
	74	C.C. CASE	1	CWG565614	

(NOTE)

- All parts are supplied from PAPAMY, Malaysia (Vendor Code: 00029488).
- "O" marked parts are recommended to be kept in stock.