



# USB Connector B DIP Type

## ■ MATERIAL

Insulator : Polyester  
Contact Pin : Copper Alloy  
Shell : Brass

## ■ SPECIFICATION

Current Rate : 1 AMP at 250V DC  
Insulation Resistance : 1000MΩMin. at DC 500V  
Contact Resistance : 30mΩMax. at DC 100mA



## ■ Detail Dimensions

984-21-6041x1

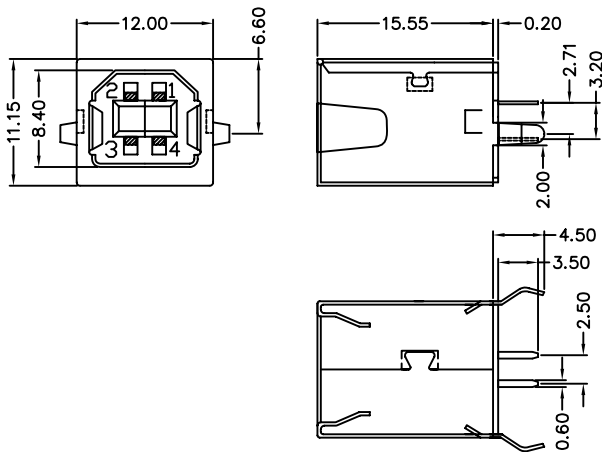

984-21-6042x1

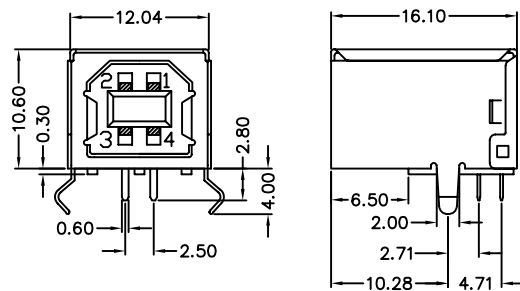

## ■ Recommended P.C.B Layout

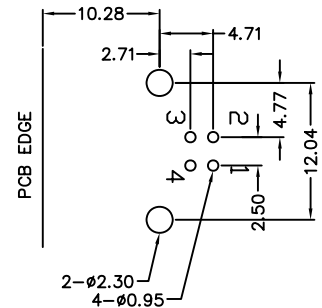
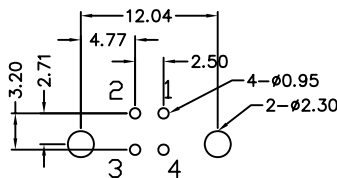

## ■ Order Information

984-2 1 - 604 x x 1  
1 2 3 4

1. 1: Tray package
2. No. of contacts
3. 1: Straight Type  
2: Right Angle Type
4. 0: Black Insulator  
1: White Insulator

| Standard Parts |
|----------------|
| 984-21-6041x1  |
| 984-21-6042x1  |

Unit: mm